

Flo~mate Mains Boost Pump



Flo~mate offers a simple solution to boost mains water pressure without the need for a cold water break tank and is designed to be connected directly to the incoming mains. Flo~mate is fully WRAS approved and operates within the current UK Water Regulations.

Application

At times when there is insufficient mains water pressure Flo~mate is designed to ensure that the pump will deliver an additional 1.5 bar to any existing mains pressure at a maximum flow rate of 12 l/min, meeting the requirements of most combination boilers. The pump also features a built-in bypass, meaning that when the mains pressure exceeds 1.5 bar, the additional performance is not restricted. The pump will automatically start when a flow rate of 0.6 l/min or more exists.

Features

- WRAS approved
- Fully automatic
- Easy installation
- Max. flow 12 l/min
- Patent pending

Materials

Body	Brass
Impeller	Brass
Pump shaft	Stainless steel
Seal	Nitrile/carbon/silicon

Operating Conditions

Max. water temp.	35°C
Min. water temp.	4°C
Suction	Flooded
Max. ambient air temp.	40°C
Max. inlet pressure	3.0 bar
Min. flow	0.6 l/min

Pump Connection Sizes

Inlet	G 3/4 Male
Outlet	G 3/4 Male

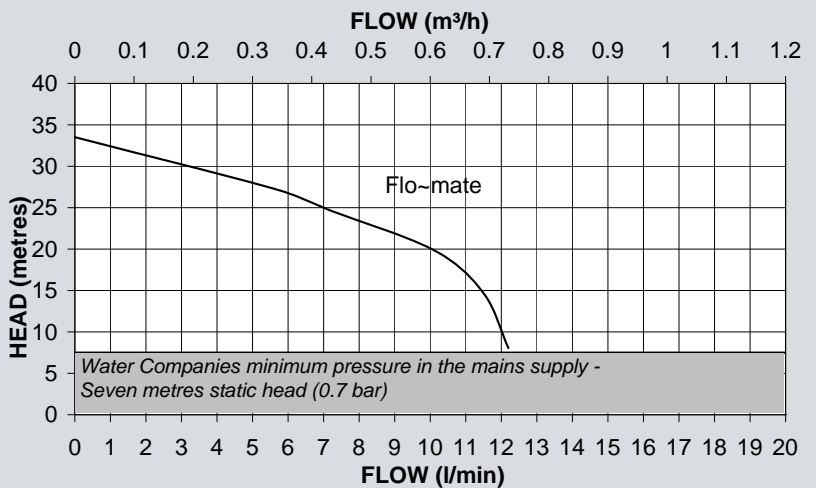

Flo~mate

Mains Boost Pump

Model	Motor*	Nominal watts	Max. watts consumed	Amps full load	Seal	Carton dims. mm			Gross weight (packed) kg	Part no.
						L	W	H		
Flo~mate	230/1/50	180	500	2.2	Nit/Car/Sil	271	159	291	5.8	46574

*Built to IPX4, this pump is designed for continuous running @ 2.5 l/min and above and feature totally enclosed fan ventilated cooling with integral thermal overload protection.

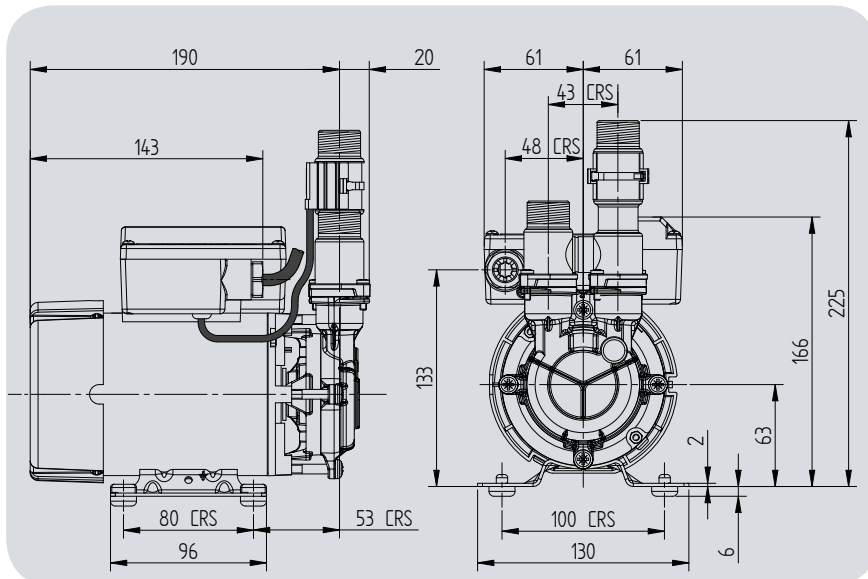

All dimensions shown are in mm.

The following ancillary items must be fitted to complete any installation (not supplied with the Flo~mate pump).

Type EC - verifiable double check valve

Pressure regulator (set at 3.0 bar)

2 off G $\frac{3}{4}$ > 22 mm full bore isolating valves

Pressure relief valve (set to 6.0 bar)

Plumbing fittings

Stuart Turner Ltd
Henley-on-Thames
Oxfordshire RG9 2AD
England
Telephone: +44 (0)1491 572655
Fax: +44 (0)1491 573704

Email:
pumps@stuart-turner.co.uk
Web:
www.stuart-turner.co.uk

V.A.T. REG. No. 199 0987 92.
Registered in England No. 88368.
Registered Office:
Market Place, Henley-on-Thames

**STUART
TURNER**